

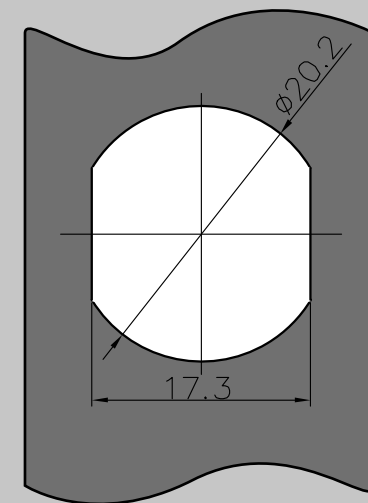

PRODUCT SPECIFICATION

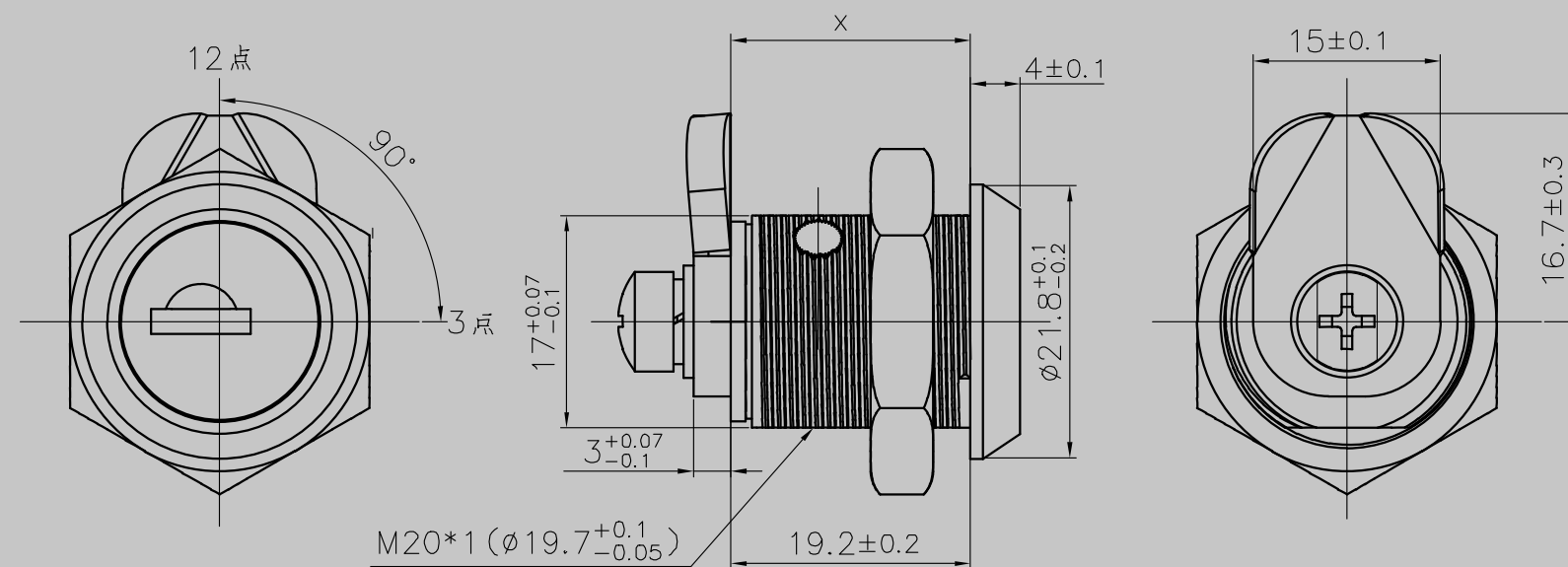

Material	Zinc alloy , brass
Finished	Bright chrome, bright nickel
Key combination	3600 group
Application	Intellectualized terminal, financial equipment, electrical equipment, cabinets, public telephone, game machine, underground strobe, vending machine, lockers, safes, advertising box, automatic washing machine, refuelling equipment, locomotives, mail box and toolbox, etc.
Speciality	1.Top security dimple key system, handle smoothly. 2. Two lines of pins, higher security. 3. Customer-oriented development available.