

Technical Requirements

- 1 DESING AND MANUFATORY AS PER: BS EN593
- 2 PRESSURE TEST AS PER: BS EN12266-1
- 3 FACE TO FACE DIMENSIONS AS PER: Customer provide
- 4 FLANGE DIMENSIONS AS PER: EN 1092-2 PN10
- 5 TOP FLANGE DIMENSIONS AS PER: ISO 5211

Bosseal Valves

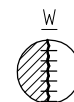
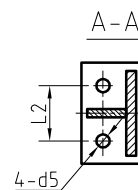

						ASSEMBLY DRAWING				Bosseal Valve(Suzhou) Co., Ltd.							
														Soft Sealing Double Eccentric Butterfly Valve			
Mark	No.	Change File No.	Sign	Date						1800D042X-E10Q06/M5111							
Designer		ZXA	Standardization		Drawing Mark			Weight	Scale								
Corrector			Authorized														
Auditor			Approved by		Total		Pages	The	Page								
Technologist			Date														