

# Class 150 LUG Type Ends Butterfly Valve ASTM A216 WCB NACE

NO.	PART NAME	MAT'L (ASTM)	Q'TY	NOTE
01	Body	ASTM A216-WCB	1	
02	Insert	ASTM A105	1	
03	Seat	RPTFE+F316	1	
04	Disc	ASTM A351-CF8M	1	
05	Stem	17-4PH	1	
06	Sleeve	316L+RPTFE	1	
07	Packing	Graphite	1SET	
08	Gland Flange	ASTM A216-WCB	1	
09	Pin	17-4PH	1SET	
10	Retainer	F316L	2	
11	Upper Bush Bearing	316SS+PTFE	1	
12	Gland Bolt	ASTM A193-B7M+ZN	2	
13	Gland Nut	ASTM A194-2HM+ZN	2	
14	Spring Washer	ASTM A276-316	2	
15	Screw	ASTM A193-B7M+ZN	4	
16	Spring Washer	ASTM A276-316	4	
17	Screw	ASTM A193-B7M+ZN	1SET	
18	Worm Gear	ASTM A216 WCB	1	
19	Gland	ASTM A276-304	1	

Item	SIZE	UNIT	φA	B	C	FTF±3.3	φK	N-W	ISO FLANGE	□Z	H	φh	L1	APPROX. WEIGHT UNFEB (kg)
4	8"	INCH	7.4	7.36	6.77	2.52	11.75	8 - 3/4"-10UNC	F10	0.87	4.31	9.84	6.57	108(49)
		MM	188	187	172	64	298.5			22	111	250	200	
5	12"	INCH	11.1	10.24	9.49	3.19	17	12 - 7/8"-9UNC	F12	1.06	4.76	11.81	7.48	185(84)
		MM	282	260	241	81	431.8			27	121	300	230	
6	14"	INCH	12.36	12.4	11.61	3.62	18.75	12 - 1"-8UN	F14	1.42	7.95	13.78	8.46	326.3(148)
		MM	314	315	295	92	476.3			36	202	350	285	

- Notes:
1. Fire safe design according to API 607, seventh edition.
  2. Unless specially requested by client, back side sealing pressure is up to 87PSI.



TITLE: CAST STEEL HP BUTTERFLY VALVE		CLASS 150 - WCB BODY - LUG TYPE - DOUBLE OFFSET - GEAR OPERATED	
MATERIAL: ASTM A216-WCB	UNITS: Inch, mm	CLASS: 150	DATE: 10/16/20
MARKING SYSTEM: MSS-SP-25	INSPECTION & TEST: API 598	FACE TO FACE: API 609	SCALE: N.T.S.
DIM.OF FLANGE: ANSI B16.5	SHELL: HYDRO 435PSI	DESIGNED: API 609, B16.34	FIG. No.: 8TB1LWCB
SEAT: AIR 80PSI	HYDRO 315PSI	DRAWN BY:	CHK'D & APR'D BY:
NACE MR-0103		REV:	DWG No.:

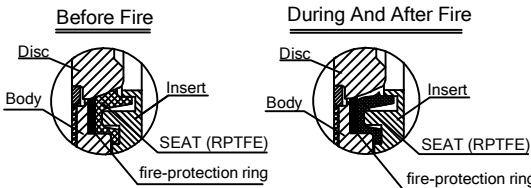
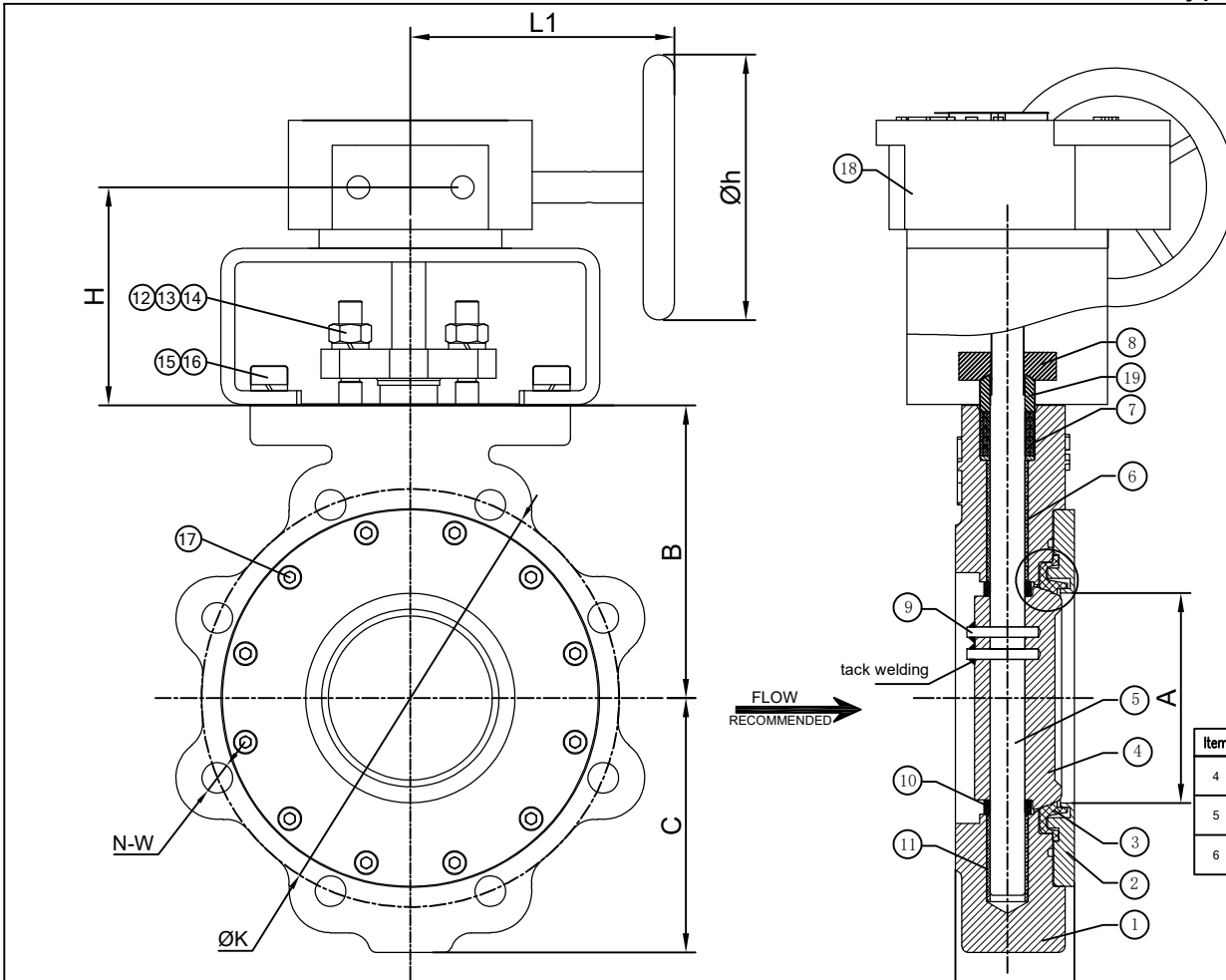

MARKING SYSTEM: MSS-SP-25	INSPECTION & TEST: API 598	MATERIAL: ASTM A216-WCB	UNITS: Inch, mm
DIM.OF FLANGE: ANSI B16.5	SHELL: HYDRO 435PSI	CLASS: 150	DATE: 10/16/20
FACE TO FACE: API 609	SEAT: AIR 80PSI	SIZE: 8", 12", 14"	SCALE: N.T.S.
DESIGNED: API 609, B16.34	HYDRO 315PSI	DRAWN BY:	FIG. No.: 8TB1LWCB
NACE MR-0103		CHK'D & APR'D BY:	REV:
			DWG No.: