

VALVE SIZE	DIMENSION mm.		
	L	D	D1
10"-300LB	146	359	270

Performance Standard		
Nominal CL (PN)	300LB	Test medium
Shell test pressure	7.8MPa	Water
Seal test pressure	5.7MPa	
Air test pressure	- MPa	Air
Suitable temperature	-29~120℃	
Suitable medium	Water/Steam/Oil etc	

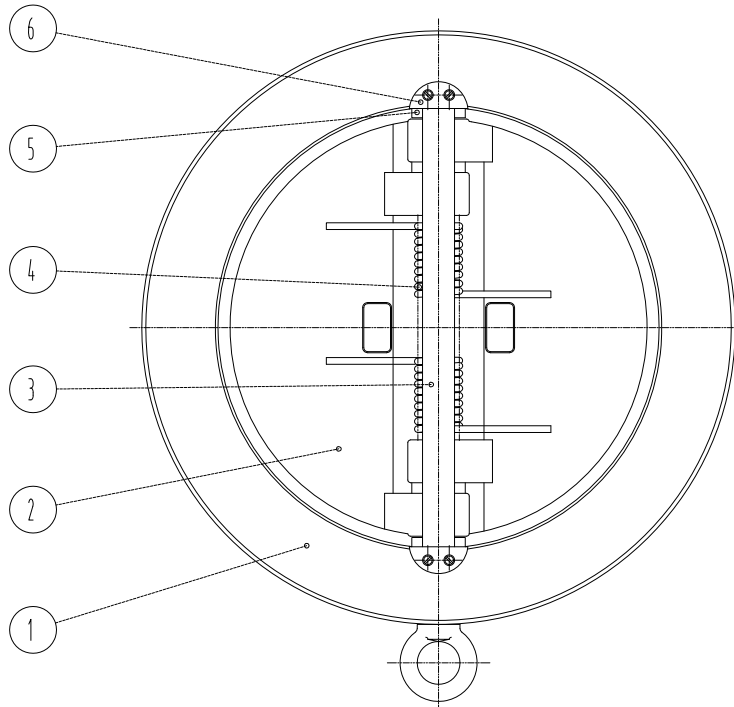
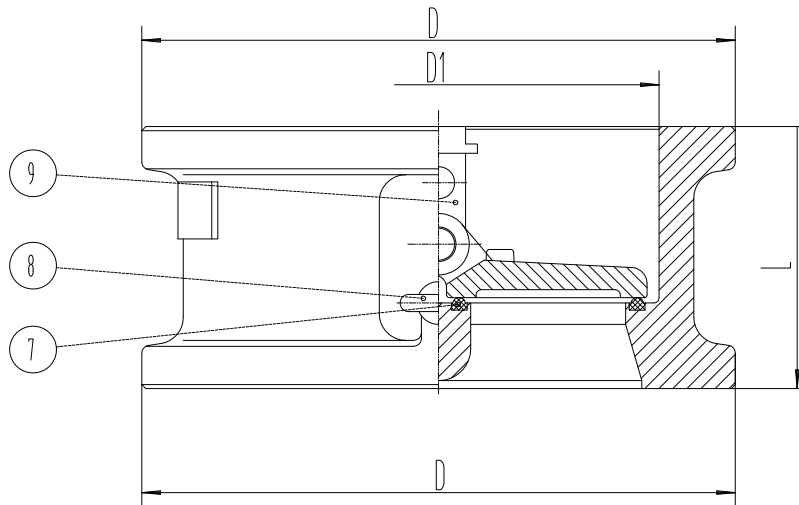

Bosseal Valves

9	Pin Holder	ASTM A995 6A	
8	Eye Bolt	S.S.	
7	Seat	VITON	
6	Holder Lock	ASTM A182 F55	
5	Bearing	ASTM A182 F55	
4	Spring	INCONEL X-750	
3	Pin	ASTM A182 F53	
2	Plate	ASTM A995 6A	
1	Body	ASTM A995 6A	
NO.	PARTS NAME	MATERIAL	REMARK

Wafer Type Dual Plate Check Valve

Size	10"	Design&Manu	API 594
Class	300Lb	Inspection&Test	API 598
Rev.	00	End Connection	ASME B16.5
Man.Fig.		Face-to-face dimension	API 594

Bosseal Valve(Suzhou) Co., Ltd