

NPS >12

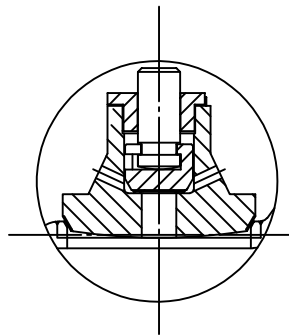

NPS >10
Completed with double disc

Nominal Diameter		Main Dimension mm class150									
inch	mm	d	D	D1	D2	b	n-Ød	L	Hopen	W	
2"	50	51	150	120.7	92.1	14.3	4-Ø19.1	203	326	200	
2 1/2"	65	64	180	139.7	104.8	15.9	4-Ø19.1	216	344	250	
3"	80	76	190	152.4	127	17.5	4-Ø19.1	241	403	280	
4"	100	102	230	190.5	157.2	22.3	8-Ø19.1	292	460	300	
6"	150	152	280	241.3	215.9	23.9	8-Ø22.2	406	528	350	
8"	200	203	345	298.5	269.9	27	8-Ø22.2	495	730	400	
10"	250	254	405	362.0	323.8	28.6	12-Ø25.4	622	817	450	
12"	300	305	485	431.8	381	30.2	12-Ø25.4	698	795	460	
14"	350	337	535	476.3	412.8	33.4	12-Ø28.6	787	851	460	
16"	400	387	595	539.8	469.8	35	16-Ø28.6	914	892	460	
18"	450	438	635	577.9	533.4	38.1	16-Ø31.8	978		460	
20"	500	489	700	635.0	584.2	41.3	20-Ø31.8	978		460	
24"	600	591	815	749.3	692.2	46.1	20-Ø34.9	1295		460	

18	Gear Box	Ductile Iron	
17	Hand Wheel	Ductile Iron	
16	Stem Nut	A439 D2	
15	Gland Nut	ASTM A194 2HM	
14	Gland Eyebolt	ASTM A193 B7M	
13	Gland Flange	ASTM A216 WCB	
12	Gland	ASTM A182 F6a	
11	Stem Packing	Graphite	
10	Bonnet Nut	ASTM A194 2HM	
9	Bonnet Bolt	ASTM A193 B7M	
8	Bonnet	ASTM A216 WCB	
7	Backseat bushing	ASTM A182 F6a	
6	Gasket	Graphite+304	
5	Stem	ASTM A182 F6a	
4	Disc Nut	ASTM A182 F6a	
3	Disc	A216 WCB+13Cr	
2	Seat Ring	ASTM A105+STL	
1	Body	ASTM A216 WCB	

NO	PART NAME	MATERIAL	REMARKS
GLOBE VALVE CLASS150			
Design and Manufacture		BS 1873	
Face to Face Dimensions		ANSI B16.10	
Flange Ends Dimensions		ANSI B16.5	
Pressure Test		API STD.598	
Bosseal Valve(Suzhou) Co.,Ltd.			