

Nominal Diameter		Main Dimension (mm)				Sch.
NPS	DN	d	A	B	L	
3"	80	69	91	66.6	470	160

Performance Standard		
Nominal CL (PN)	1500LB	Test medium
Shell test pressure	38.4MPa	Water
Seal test pressure	28.1MPa	
Air test pressure	0.6 MPa	Air
Suitable temperature	-10~538℃	
Suitable medium	Water/Steam/Oil etc	

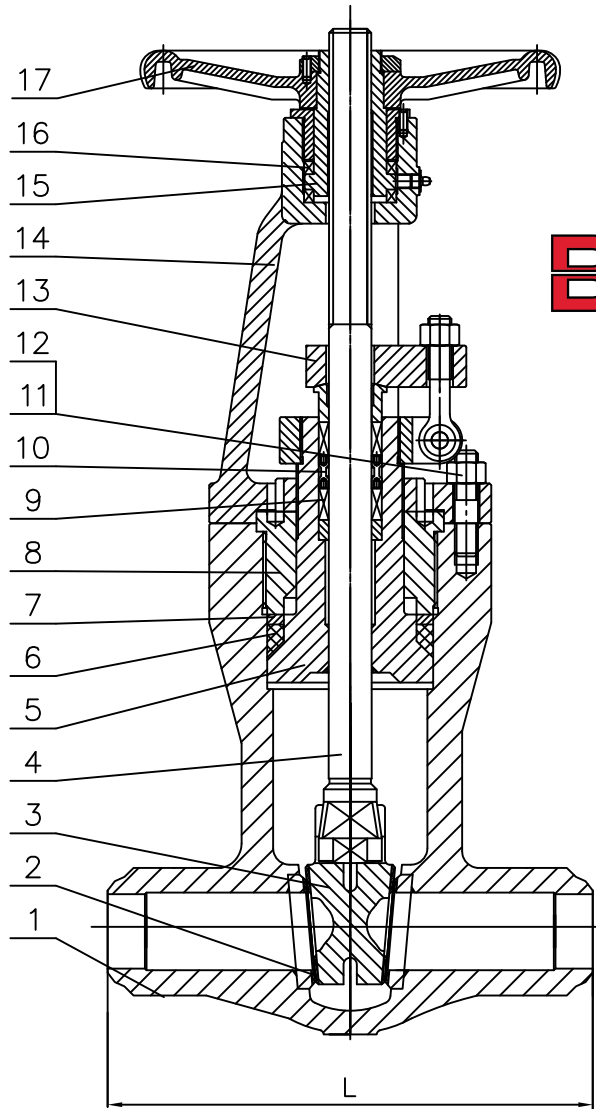

Bosseal Valves

PO item: 11

TAG: VGASPO3ABWC7F5G

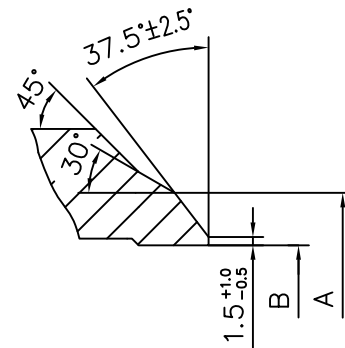

Butt-Weld End Amplification

17	Hand Wheel	ASTM A536 60-40-18	
16	Plane Bearing	Alloy Steel	
15	Stem Nut	Copper Alloy	
14	Yoke	ASTM A217 WC6	
13	Gland Flange	ASTM A217 WC6	
12	Yoke Nut	ASTM 7	
11	Yoke Bolt	ASTM B16	
10	Packing Ring	ASTM A276 420	
9	Stem Packing	Graphite With inconel wire	
8	Top Cover	ASTM A182 F6A	
7	P.S.ring	ASTM A182 F6A	
6	Seal Gasket	Graphite+SS304	
5	Bonnet	ASTM A182 F6A	
4	Stem	ASTM A182 F6a	
3	Flexible Wedge	ASTM A217 CA15+STL	
2	Seat Ring	ASTM A182 F6A+STL	
1	Body	ASTM A217 WC6	
NO.	PARTS NAME	MATERIAL	REMARK

Gate Valve-PSB

Size	3"	Design&Manu	API 600
Class	1500Lb	Inspection&Test	API 598
Rev.	00	End Connection	ASME B16.25-BW
Man.Fig.		Face-to-face dimension	ASME B16.10

Bosseal Valve(Suzhou) Co., Ltd