

The Recommended Spare Parts for Brushless Alternator

无刷发电机建议备用件

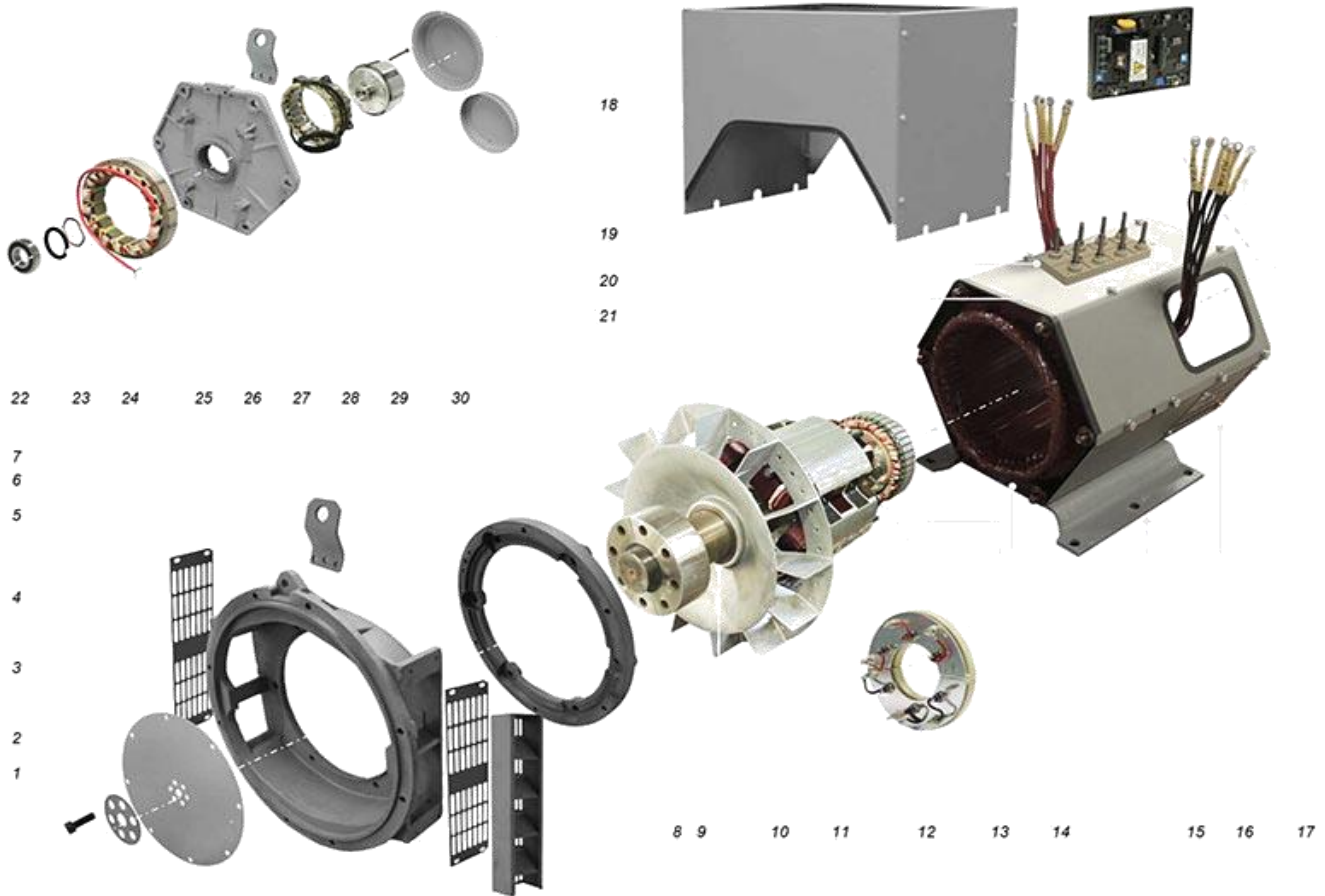

| No. | Description | No. | Description | No. | Description |
|-----|-------------------|-----|------------------|-----|-------------------------|
| 1 | Bolt | 11 | Rotor Assembly | 21 | Cover |
| 2 | Drive Plate | 12 | Diode Assembly | 22 | Non-Drive End Bearing |
| 3 | Coupling Disc | 13 | Excitor Rotor | 23 | Rubber Ring |
| 4 | Air Outlet Screen | 14 | Stator Assembly | 24 | Spring Washer |
| 5 | Drive End Adaptor | 15 | Foot | 25 | Excitor Stator Assembly |
| 6 | Lifting | 16 | Air Inlet Screen | 26 | Non-Drive End Bracket |
| 7 | Adaptor Ring | 17 | Terminals | 27 | PMG Stator |
| 8 | Driving Hub | 18 | AVR | 28 | PMG Rotor |
| 9 | Shaft | 19 | Terminal Box | 29 | PMG Plastic Conver |
| 10 | Fan | 20 | Termial Board | 30 | NON -PMG Plastic Cover |