

The Recommended Spare Parts for 3 Cylinder Diesel Engine

3缸柴油机建议备用件

1、★ The marked spare parts should be replaced according to wear and damage; 2、▲ The marked spare parts can be stocked for every 4-5 sets; 3、Please replace the lubricating oil and coolant strictly according to the operating instructions.

1、带★标记的配件视磨损、损坏情况更换; 2、带▲标记的配件可按每4-5台机器备货; 3、润滑油和冷却液请严格按照使用说明书更换。

Description	中文	Units	Qty/Set	50-100h	500h	1000h	2000h	5000h
Oil filter	机油滤芯	Pcs	1	1	3	6	10	20
Fuel filter	燃油滤芯	Pcs	1	1	2	3	5	10
Air filter	空滤芯	Pcs	1		1	2	4	8
Belt	皮带	Pcs	1		1	2	4	6
Cylinder head gasket	汽缸垫	Pcs	1			1	2	4
Head cover gasket	气缸盖罩密封垫	Pcs	1		1	3	6	8
Oil seal-air gate	气门导管密封圈	Pcs	6		6	12	18	24
Front oil seal	前油封	Pcs	1			2	4	8
Rear oil seal	后油封	Pcs	1			1	2	4
Paper gasket kit	全车垫(纸)	Pcs/Set	1				1	1
Thermostat	节温器★	Pcs	1			1	1	2
Cylinder liner	缸套★	Pcs	3			3	3	6
Water seal ring	水封圈	Pcs	6			6	6	12
Piston ring	活塞环★	Pcs/Set	1			1	1	2
Piston ring	活塞环★	Pcs/Set	1			1	1	2
Piston	活塞★	Pcs	3				3	6
Piston pin	活塞销★	Pcs	3				3	6
Connecting rod bush	连杆小头衬套★	Pcs	3				3	6
Rod bearing shell	连杆轴承瓦★	Pcs/Set	1				1	1
Main bearing shell	曲轴轴承瓦★	Pcs/Set	1				1	1
Fuel pump	喷油泵总成▲	Pcs	1				1	1
Injector	喷油器总成▲	Pcs	3			3	3	6
Oil pump	机油泵总成▲	Pcs	1				1	1
Water pump	水泵▲	Pcs	1			1	1	2
Start motor	起动机▲	Pcs	1			1	1	2
Alternator	发电机▲	Pcs	1			1	1	2
Water temperature sensor	水温传感器▲	Pcs	1			1	1	1
Oil pressure sensor	机油压力传感器▲	Pcs	1			1	1	1

The Recommended Spare Parts for 4 Cylinder Diesel Engine

4缸柴油机建议备用件

1、★ The marked spare parts should be replaced according to wear and damage; 2、▲ The marked spare parts can be stocked for every 4-5 sets; 3、Please replace the lubricating oil and coolant strictly according to the operating instructions.

1、带★标记的配件视磨损、损坏情况更换; 2、带▲标记的配件可按每4-5台机器备货; 3、润滑油和冷却液请严格按照使用说明书更换。

Description	中文	Units	Qty/Set	50-100h	500h	1000h	2000h	5000h
Oil filter	机油滤芯	Pcs	1	1	3	6	10	20
Fuel filter	燃油滤芯	Pcs	1	1	2	3	5	10
Air filter	空滤芯	Pcs	1		1	2	4	8
Belt	皮带	Pcs	1		1	2	4	6
Cylinder head gasket	汽缸垫	Pcs	1			1	2	4
Head cover gasket	汽缸盖罩密封垫	Pcs	1		1	3	6	8
Oil seal-air gate	气门导管密封圈	Pcs	8		8	16	32	48
Front oil seal	前油封	Pcs	1			2	4	8
Rear oil seal	后油封	Pcs	1			1	2	4
Paper gasket kit	全车垫(纸)	Pcs/Set	1				1	1
Thermostat	节温器★	Pcs	1			1	1	2
Cylinder liner	缸套★	Pcs	4			2	2	4
Water seal ring	水封圈	Pcs	8			8	8	16
Piston ring	活塞环★	Pcs/Set	1			1	1	2
Piston	活塞★	Pcs	4				4	6
Piston pin	活塞销★	Pcs	4				4	6
Connecting rod bush	连杆小头衬套★	Pcs	4				4	6
Rod bearing shell	连杆轴承瓦★	Pcs/Set	1				1	1
Main bearing shell	曲轴轴承瓦★	Pcs/Set	1				1	1
Fuel pump	喷油泵总成▲	Pcs	1				1	1
Injector	喷油器总成▲	Pcs	4			4	4	6
Oil pump	机油泵总成▲	Pcs	1				1	1
Water pump	水泵▲	Pcs	1			1	1	2
Start motor	起动机▲	Pcs	1			1	1	2
Alternator	发电机▲	Pcs	1			1	1	2
Water temperature sensor	水温传感器▲	Pcs	1			1	1	1
Oil pressure sensor	机油压力传感器▲	Pcs	1			1	1	1

The Recommended Spare Parts for 6 Cylinder Diesel Engine

6缸柴油机建议备用件

1、★ The marked spare parts should be replaced according to wear and damage; 2、▲ The marked spare parts can be stocked for every 4-5 sets; 3、Please replace the lubricating oil and coolant strictly according to the operating instructions.

1、带★标记的配件视磨损、损坏情况更换; 2、带▲标记的配件可按每4-5台机器备货; 3、润滑油和冷却液请严格按照使用说明书更换。

Description	中文	Qty/Set	Qty/Set	50-100h	500h	1000h	2500h	5000h
Oil filter	机油滤芯	Pcs	1	1	3	6	10	20
Fuel filter	燃油滤芯	Pcs	1	1	2	3	5	10
Air filter	空滤芯	Pcs	1		1	2	4	8
Belt	皮带	Pcs	1		1	2	4	6
Cylinder head gasket	汽缸垫	Pcs	1			1	2	4
Head cover gasket	汽缸盖罩密封垫	Pcs	1		1	3	6	8
Oil seal-air gate	气门导管密封圈	Pcs	12		12	12	24	48
Front oil seal	前油封	Pcs	1			1	2	4
Rear oil seal	后油封	Pcs	1			1	2	4
Paper gasket kit	全车垫(纸)	Pcs/Set	1				1	1
Thermostat	节温器★	Pcs	1			1	1	2
Cylinder liner	汽缸套	Pcs	6			6	6	12
Piston ring	活塞环★	Pcs/Set	1			1	1	2
Piston	活塞★	Pcs	6				6	12
Piston pin	活塞销★	Pcs	6				6	12
Connecting rod bush	连杆小头衬套★	Pcs	6				6	12
Rod bearing shell	连杆轴承瓦★	Pcs/Set	1				1	1
Main bearing shell	曲轴轴承瓦★	Pcs/Set	1				1	1
Fuel pump	喷油泵总成▲	Pcs	1				1	1
Injector	喷油器总成▲	Pcs	6			6	6	6
Oil pump	机油泵总成▲	Pcs	1				1	1
Turbocharger	涡轮增压器▲	Pcs	1				1	1
Water pump	水泵▲	Pcs	1			1	1	2
Start motor	起动机▲	Pcs	1			1	1	2
Alternator	发电机▲	Pcs	1			1	1	2
Water temperature sensor	水温传感器▲	Pcs	1			1	1	2
Oil pressure sensor	机油压力传感器▲	Pcs	1			1	1	2

The Recommended Spare Parts for Brushless Alternator

无刷发电机建议备用件

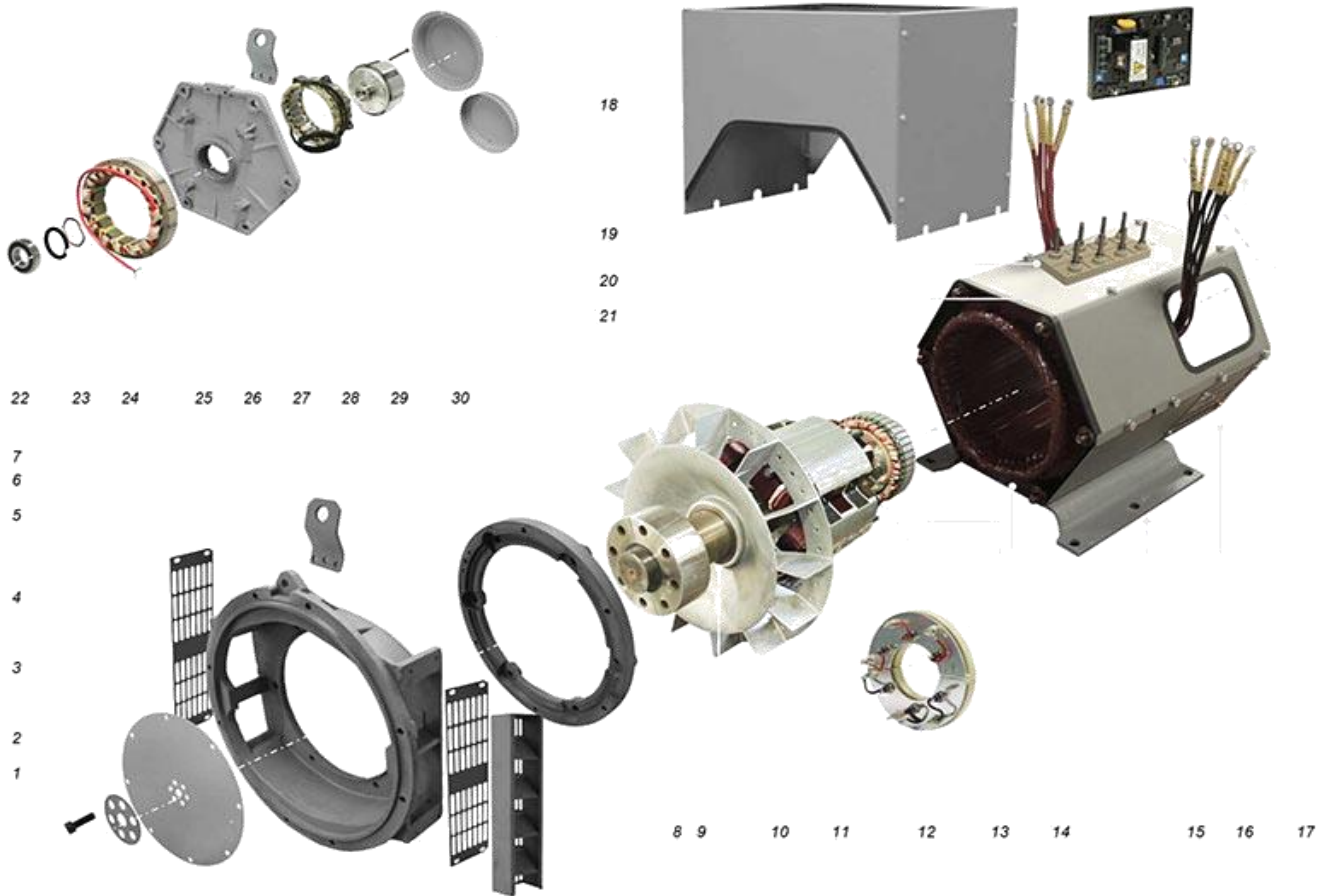

No.	Description	No.	Description	No.	Description
1	Bolt	11	Rotor Assembly	21	Cover
2	Drive Plate	12	Diode Assembly	22	Non-Drive End Bearing
3	Coupling Disc	13	Excitor Rotor	23	Rubber Ring
4	Air Outlet Screen	14	Stator Assembly	24	Spring Washer
5	Drive End Adaptor	15	Foot	25	Excitor Stator Assembly
6	Lifting	16	Air Inlet Screen	26	Non-Drive End Bracket
7	Adaptor Ring	17	Terminals	27	PMG Stator
8	Driving Hub	18	AVR	28	PMG Rotor
9	Shaft	19	Terminal Box	29	PMG Plastic Conver
10	Fan	20	Termial Board	30	NON -PMG Plastic Cover

NM1 SERIES MOULDED CASE CIRCUIT BREAKER

NM1 series MCCB has a rated insulation voltage of 800V, suitable for AC 50Hz, rated operating voltage of 415V (3P), 230V / 240V (1P), and rated operating current from 10A to 125A in the distribution network circuit. It is used to distribute electrical energy and protect lines and the power supply equipment from damages such as overload and short circuit. This circuit breaker has the characteristics of small size and short flashover, and is an ideal product for users. The circuit breaker is installed vertically, and it can also be installed horizontally. The product has isolation function.

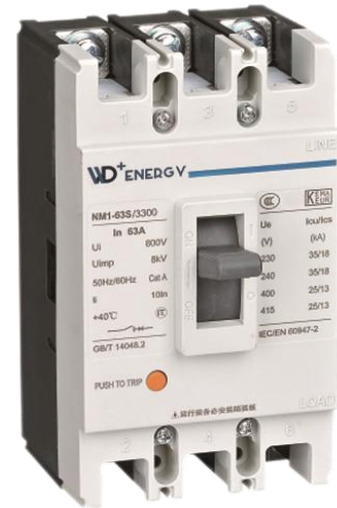

Model	Pole	Rated Current(A)	Rated Working Voltage(V)	Rated Insulation Voltage(V)	Icu (Rated limit short circuit breaking capacity)			Arc Distance (mm)
					Test voltage(V)	ICU(kA)	Ics(kA)	
NM1-63S	3、4	10、16、20、 25、32、40、 50、63	400	800	400X1.1	22	18	0
NM1-125S	3、4	10、16、20、 25、32、40、 50、63、80、 100、125	400/690	800		35	22	≤50
NM1-250S	3、4	100、125、140 、160、180、 200、225、250	400/690	800		35	22	≤50
NM1-400S	3、4	225、250、315 、350、400	400/690	800		65	50	≤100
NM1-630S	3、4	400、500、630	400/690	800		75	65	≤100
NM1-800S	3、4	630、700、800	400/690	800		85	75	≤100
NM1-1600S	3、4	800、1000、 1250、1600	400/690	800		85	65	≤100

BAC06A SERIES BATTERY CHARGE

BAC06A series battery charger adopts the latest switch power components, which is designed for charging lead-acid starting battery according to its property. The charger is suitable for lead-acid battery float charge. The maximum charge current for 12V charger is 6A; the maximum charge current for 24V charger is 3A.



PERFORMANCE AND CHARACTERISTICS

- 1、 Designed in switching power structure, wide range of AC voltage input, small volume, light weight and high efficiency;
- 2、 Two-stage charging method (constant current firstly and then constant voltage), fully considering charging property of the lead-acid battery, can avoid overcharging and extend the battery life to the fullest;
- 3、 With short circuit and reverse connection protection;
- 4、 Charging voltage and current can be adjusted via potentiometer on site;
- 5、 LED display: Power indication and charging indication;
- 6、 Horizontal type for installation of BAV06A, easy to install;

Function Item		
Battery Voltage	12V	24V
Max. Charging Current	6A	3A
Rated Input Voltage	AC(95~280)V	
Max. Input Voltage Range	AC(90~305)V	
AC Input Frequency	(50/60)Hz	
Max. Input Current	2A	
No-Load Power Consumption	<3W	
Operating Mode	Two segments	
Maximum Efficiency	0.85	
Operating Temp.	(-30~+55)°C	
Storage Temp.	(-40~+85)°C	
Net Weight(kg)	0.65	
Dimensions(mm)	143*96*55	

SKT SERIES ATS

SKT series automatic transfer switch is the most advanced third generation ATS. It's of PC Class. SKT standard type is able to operate the current from 20A to 3200A.

FEATURES

- 1、 Voltage and Switch Working Conditions Indications Using LED;
- 2、 External Replaceable Fuses, Easy For Maintenance;
- 3、 Built-in Microprogrammed Control Unit Realise Voltage Detection Function;
- 4、 Silver Plated High Purity Copper Bars;
- 5、 Brige Connect Structure on Load Side;
- 6、 Three-Sections Design (I – 0 – II), Zero Position For Dual Powers Off;
- 7、 Pluggable Wiring Terminals;
- 8、 Mechanical Interlock & Electrical Interlock;



Technial Parameters

Shell frame grade current Inm	160A		250A	630A	
Rated current In	125A	160A	250A	400A	630A
Conventional thermal current Ith	63,80,100,125,140,150,160A		160,180,200,225,250A	160,180,200,225,250,315,350,400,500,630A	
Rated insulation voltage of copper bar Ui	660V				
Rated impulse withstand voltage Uimp	6KV				
Rated operating voltage of copper bar Ue	AC400V				
Use category	AC-33A				
Rated operating current of copper bar Ie	10,16,20,25,32,40,50,63,80,100,125,140,150,160,180,200,225,250,315,350,400,500,630A				
Rated making capacity	10Ie				
Rated breaking capacity	10Ie				
Rated limit short-circuit current	13KA		35KA		
Transferring time	1.2S			0.6S	
Rated operating voltage of control power Us	AC220V(special voltage DC24V, DC110V, DC220V, AC110V, AC280V)				
Start	40W			325W	
Normal	18W			62W	
Weight	5.3KG	5.5KG	7KG	17KG	17.5KG



Technical Parameters

Shell frame grade current I_{nm}	1600A			
Rated current I_n	800A	1000A	1250A	1600A
Conventional thermal current I_{th}	800,1000,1250,1600A			
Rated insulation voltage of copper bar U_i	800V			
Rated impulse withstand voltage U_{imp}	8KV			
Rated operating voltage of copper bar U_e	AC400V			
Use category	AC-33A			
Rated operating current of copper bar I_e	800,1000,1250,1600,2000,2500,3200A			
Rated making capacity	10Ie			
Rated breaking capacity	10Ie			
Rated limit short-circuit current	50KA			
Transferring time	1.2S			
Rated operating voltage of control power U_s	AC220V(special voltage DC24V, DC110V, DC220V, AC110V, AC280V)			
Start	355W	400W	440W	
Normal	74W	90W	98W	
Weight	37KG	37KG	37KG	44KG

Belt Spanner

Concave-convex gear, bite fastening does not slip

The whole glue injection adds 3 canvas layers,

Which is firm and not easy to break



Model	Specification	Handle Length	Chain Length	Suitable Diameter	Weight
BW-8	8inch	210mm	480mm	60-110mm	0.265kgs
BW-9	9inch	211mm	481mm	60-111mm	0.315kgs
BW-12	12inch	212mm	482mm	60-112mm	0.395kgs
BW-16	16inch	213mm	483mm	60-113mm	0.606kgs

Chain Spanner

65# manganese steel chain

Suitable to withstand impact, wear harsh conditions



Model	Specification	Handle Length	Chain Length	Suitable Diameter	Weight
CW-9	8inch	220mm	420mm	60-120mm	420kgs
CW-12	9inch	285mm	520mm	60-150mm	508kgs
CW-16	16inch	403mm	705mm	60-210mm	1.3kgs

Piston Ring Installer

Quickly and easily to use

Maximum working diameter up to 195mm

Use safety

Steel type



Model	Specification	Height	Suitable Diameter	Weight
RI-3	3inch	75mm	53-175mm	0.25kgs
RI-4	4inch	100mm	53-175mm	0.35kgs
RI-6	6inch	150mm	60-195mm	0.55kgs

Piston Ring Installer

Quickly and easily to use

Maximum working diameter up to 195mm

Use safety

Stainless type



Model	Specification	Height	Suitable Diameter	Weight
RI-3	3inch	75mm	53-175mm	0.25kgs
RI-4	4inch	100mm	53-175mm	0.35kgs
RI-6	6inch	150mm	60-195mm	0.55kgs

32PCS Tool Box



Dimension

280x100*45mm

Weight

4.5kgs

No.	中文	Destription
1	万向接头	Universal joint
2	火花塞套筒 (16, 21mm)	Spark plug (16, 21mm)
3	三用滑头	Adaptor
4	1/2系列接杆	1/2 Extension rod
5	六角套筒 (8,9,10,11,12,13,14,15,16, 17,18,19,20, 21.22.24.27.30.32)	6 point socket (8,9,10,11,12,13,14,15,16,1 7,18,19,20)
6	1/2快脱棘轮扳手	1/2 Quick release ratchet handle
7	12角套筒 (10,12,14,15,17,19)	12 point socket (10,12,14,15,17,19)

43PCS Tool Box



Dimension

380x230*83mm

Weight

5.5kgs

No.	中文	Destription
1	两用扳手	Dual-use wrenches
2	六角套筒 (8,9,10,11,12,13,14,15,16,17 ,18,19,20,21,22,24,27,30,32)	6 Point socket (8,9,10,11,12,13,14,15,16,17,1 8,19,20,21,22,24,27,30,32)
3	12角套筒 (10,12,14,15,17,19)	12 Point socket (10,12,14,15,17,19)
4	12角套筒 (10,12,14,15,17,19)	12 point socket (10,12,14,15,17,19)
5	火花塞套筒 (16, 21mm)	Spark plug (16, 21mm)
6	1/2 5寸系列接杆	1/2 5inch Extension rod
7	1/2 10寸系列接杆	1/2 10inch Extension rod
8	万向接头	Universal joint

121PCS Tool Box



Dimension

450x340*95mm

Weight

9.0kgs

No.	中文	Destription
1	火花塞套筒(16, 21mm)	Spark plug(16, 21mm)
2	两用扳手 (8,9,10,11,12,13,14,16,17,18,19mm)	Dual-use wrenches (8,9,10,11,12,13,14,16,17,18,19mm)
3	1/4, 3/8 接杆	1/4,3/8 Extension rod
4	3/8, 1/2 接杆	3/8,1/2 Extension rod
5	6X100 螺丝刀一字十字	6X100 Screwdriver, Slotted and cross
6	测电笔	Test pencil
7	T52批头套筒	T52 Bit sleeve
8	1/4公制短套筒 (4,5,6,7,8,9,10,11,12,13mm)	1/4 Metric short sleeve (4,5,6,7,8,9,10,11,12,13mm)
	3/8公制短套筒 (9,10,11,12,13,14,15,16,17,18,19mm)	3/8 Metric short sleeve (9,10,11,12,13,14,15,16,17,18,19mm)
	1/2公短套筒 (20,21,22,24,27,30,32mm)	1/2 Metric short sleeve (20,21,22,24,27,30,32mm)
9	1/4转接头	1 / 4 Adapter
10	3/8批头套筒 PH(#1,#2),HW(3,4,5),FD(5,5,6,5),PZ(1,2),TX(20,30,40,45,50,55,60)	3 / 8 Bit socket PH(#1,#2),HW(3,4,5),FD(5.5,6.5),PZ(1,2),TX(20,30,40,45,50,55,60)
11	1/4棘轮扳手+3/8棘轮扳手+1/2棘轮扳手	1/4 Ratchet wrench + 3/8 Ratchet wrench + 1/2 Ratchet wrench
12	1/4长套筒(8,9,10,12mm)	1/4 long sleeve (8,9,10,12mm)
13	3/8长套筒 (13,14,15,17mm)	3/8 Long sleeve (13,14,15,17mm)
14	1/4弹套+旋具接杆	1/4 spring sleeve + Screwdriver extension
15	内六角扳手 (1.5,2,2.5,3,4,5,6,8,10mm)	Inner hexagon spanner (1.5,2,2.5,3,4,5,6,8,10mm)
16	20pcs批头	20pcs batch head
17	1/2万向接头, 3/8万向接头, 1/4万向接头	1/2 Universal joint, 3/8 Universal joint, 1/4 Universal joint
18	三爪扳手	Three jaw wrench